

Tooling Links

Features & Benefits

- Solid one piece machined aluminum for structural integrity.
- Machined to close tolerances for maximum clamping force of all mating components.
- Idea for simple 90 degree in line transition.
- Metric fasteners.
- Anodized finish for appearance and durability.

Tooling Links

Part Number	Length (mm)	Length (inches)
S.125.AA.136.01	69.85	2.75
S.125.AA.136.03	101.6	4.00
S.125.AA.136.04	152.4	6.00
S.125.AA.136.05	203.2	8.00
S.125.AA.136.06	254.0	10.00
S.125.AA.136.07	304.8	12.00

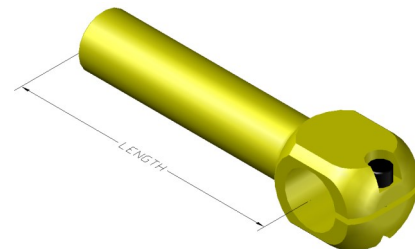

Part # S.125.AA.136.XX

If you are purchasing any of our Tooling Links, you might also want to look at our:

- *Tooling Arms*
- *Swivel Clamps*

These additional components can be found online in our Tooling section at www.atlastechnologies.com.